

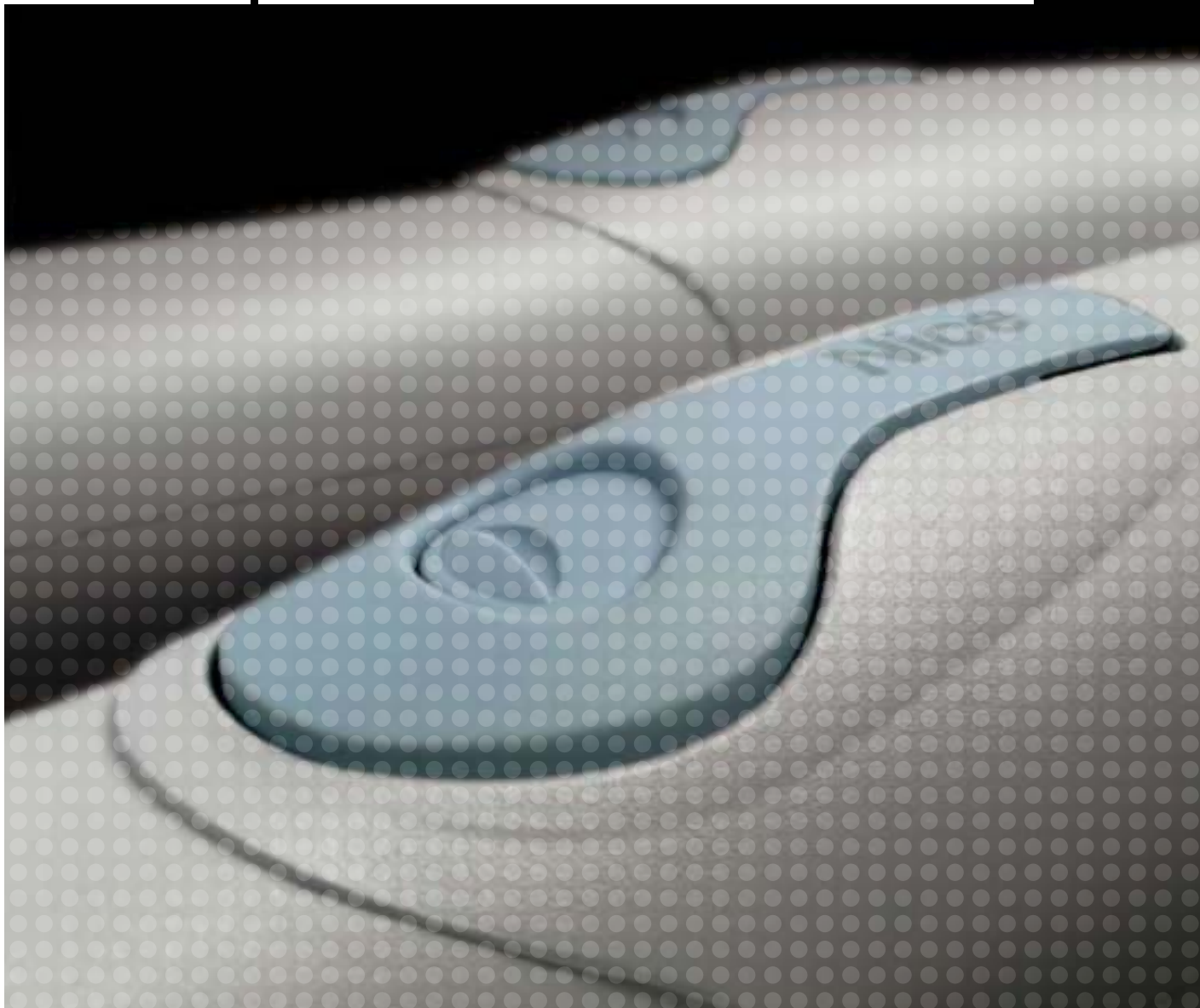

# WingoKit For swing gates



New kit for swing gates  
designed in harmony with nature  
thanks to the solar power kit Solemyo.



# Nice Wingo4024Kit - 5024Kit



**For swing gates with leaves up to 2 m (Wingo4024Kit) and up to 3,5 m (Wingo5024Kit), mounted externally.**

24 Vdc electromechanical gearmotor.

**Versions designed with provision for solar power system Solemyo**, thus enabling installation also in distant locations, far from electrical mains, with no need for connections or excavation work, in total harmony with the environment.

WG4024



User-friendly release with personalised Nice key or standard lock (optional)

WG5024

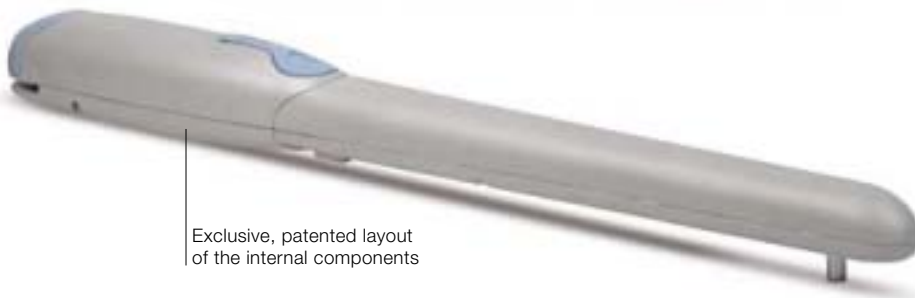

Exclusive, patented layout of the internal components

### Gear motor characteristics:

- **reliable and silent:** thanks to the patented layout of the internal components and less moving parts;
- **easy to install:** after the gear motor has been assembled, all electrical connections are made from above;
- **user-friendly release** with personalised Nice key or standard lock (optional);
- pre-assembled, **travel stops** PLA13 in opening.

### New Moonclever control unit (MC424):

- easy programming by pressing a single button;
- clutch with anti-crush safety feature;
- automatic memorization of limit switches in opening and closing with self-learning function;
- pause time programming; partial opening; slowdown during opening and closing.

**Sophisticated electronics:** slowdown, obstacle detection system, can be linked to the 8,2 KOhm resistive sensitive edge.

**No blackout:** continues to work even during power failures using optional (PS124) batteries that fit inside the control unit.

### The kit contains:



**WG4024** 2 surface-mounted electromechanical gear motors, with Nice key release (Wingo4024Kit).  
**WG5024** 2 surface-mounted electromechanical gear motors, with Nice key release (Wingo5024Kit).

Common accessories in the 2 kits:

**FLO2R-S** 1 transmitter 433.92 MHz, 2 channels. **MC424** 1 control unit with plug-in receiver SMXI.  
**MOF** 1 pair of photocells for outdoor installation. **MOSE** 1 key selector switch for outdoor installation.  
**ML24** 1 flashing light. **PLA13** 2 travel stops for opening manoeuvres. **TS** 1 signboard.

**N.B.** The content of the package may vary: consult the retailer.

## Technical specifications

Code	Description	Pz/pallet
WINGO4024KCE	Kit for swing gates with leaves up to 2 m, surface mounted	12
WINGO5024KCE	Kit for swing gates with leaves up to 3,5 m, surface mounted	12

Motor code	WG4024	WG5024
<b>Electrical specifications</b>		
Power (Vdc)	24	
Current absorbed (line) (A)	3,5	
Power absorbed (W)	85	
Built-in capacitor (µF)	-	
<b>Performance data</b>		
Speed (m/s)	0,018	0,016
Torque (N)	1500	
Work cycle (cycle/hour)	30	
<b>Dimensions and general data</b>		
Working temp. (C°)	-20 ÷ +50	
Protection level (IP)	44	
Dimensions (mm)	98x95x770	98x95x920
Weight (kg)	17	18

For updated and complete information, consult the product technical manual.

## Technical layout drawing and application limits

### WG4024

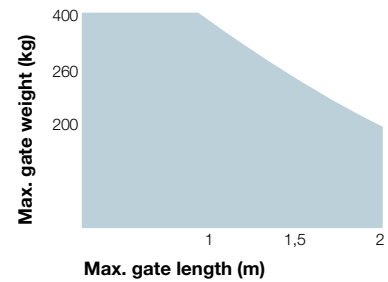
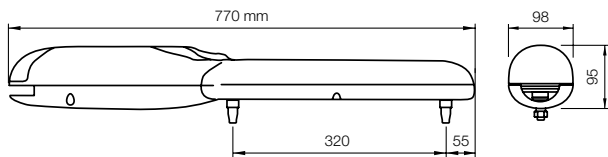

### WG5024

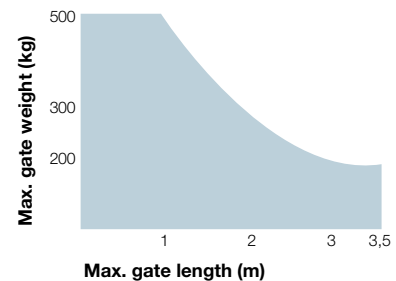
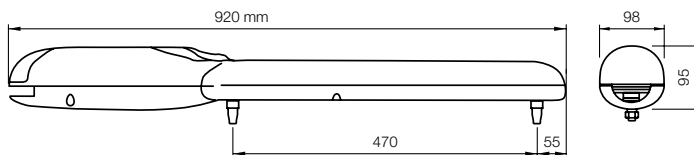

## Installation diagram

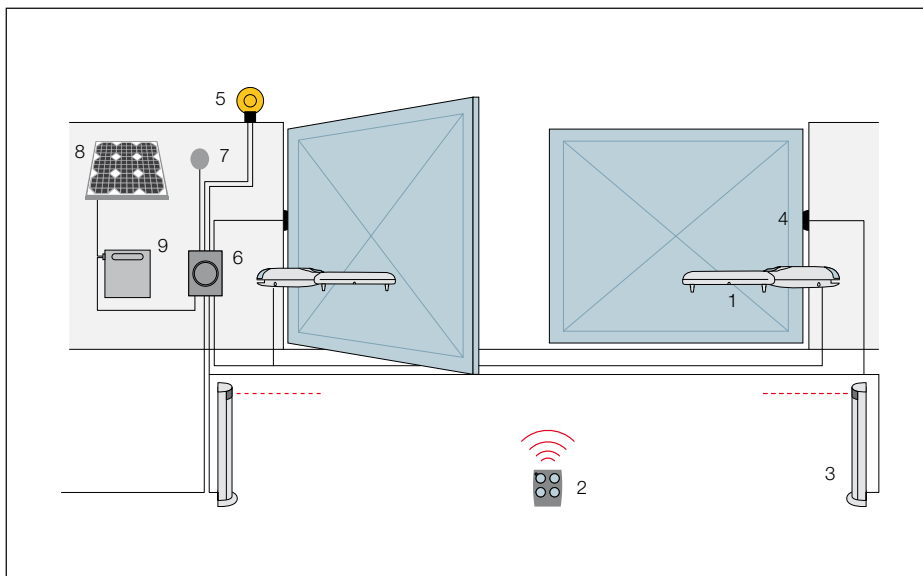

1. Wingo
2. Transmitter
3. Photocells mounted on posts
4. Photocells
5. Flashing light
6. Moonclever control unit
7. Digital or key switches
8. SYP\* solar panel
9. PSY24\* battery box

\*Optional connection to Solemyo

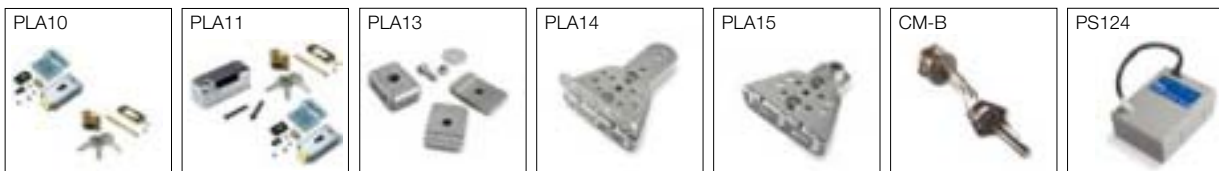
**Wingo4024Kit accessories**

Code	Description	Pc/pack
<b>PLA10</b>	Vertical 12 V electric lock (required for gates longer than 3 m)	1
<b>PLA11</b>	Horizontal 12 V electric lock (required for gates longer than 3 m)	1
<b>PLA13</b>	Mechanical travel stops for closing and opening manoeuvres	4
<b>PLA14</b>	Screw-adjustable rear bracket	2
<b>PLA15</b>	Screw-adjustable front bracket	2
<b>CM-B</b>	Lock with two metal keys compatible with SELE	-
<b>PS124</b>	24 V battery with built-in battery charger	1

**Wingo5024Kit accessories**

Code	Description	Pc/pack
<b>PLA6</b>	Rear bracket 250 mm long	1
<b>PLA8</b>	Screw-adjustable front bracket	1
<b>PLA10</b>	Vertical 12 V electric lock (required for gates longer than 3 m)	1
<b>PLA11</b>	Horizontal 12 V electric lock (required for gates longer than 3 m)	1
<b>PLA13</b>	Mechanical travel stops for closing and opening manoeuvres	4
<b>CM-B</b>	Lock with two metal keys compatible with SELE	-
<b>PS124</b>	24 V battery with built-in battery charger	1

Nice recommends customers order products in pallets in order to facilitate storage and delivery, and ensure packs are uniform. The number of packs per single pallet has been specified for this reason.

**Kit for Solemyo solar power system**

Code	Description	Pack/pallet
<b>SYKCE</b>	Solar power kit comprising SYP photovoltaic panel and PSY24 battery box with charging control circuit	21
<b>SYA1</b>	Power supply unit for charging the battery via the mains PSY24	1

**Nice for you**

Nice constantly researches the most advanced solutions for improving the quality of life by simplifying everyday movements. The key factors to Nice's success are: Technological innovation and product design; strong and proven international focus, a capacity for expansion abroad; flexible and efficient business model.

**Solemyo**

The solar power kit Solemyo to automate gates, garage doors or road barriers, without the need for costly and invasive excavation work.

**Click... Nice will take care of it!**

Nice is the only make that gives you the chance to offer integrated control systems for each type of automation, inside and outside the home.

**Nice SpA**  
 Oderzo TV Italia  
 Ph. +39.0422.85.38.38  
 Fax +39.0422.85.35.85  
 info@niceforyou.com

[www.niceforyou.com](http://www.niceforyou.com)

The information shown in this publication is purely indicative. Nice reserves the right to make any modifications to the products as it sees fit.