

BiDi-WiFi Ext

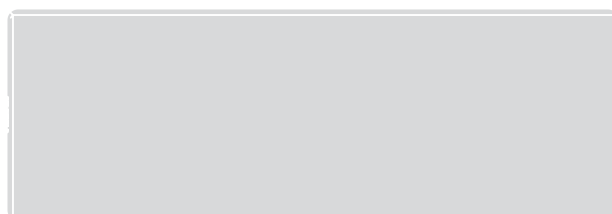

Interface

EN - Instructions and warnings for installation

1 GENERAL SAFETY WARNINGS AND PRECAUTIONS

CAUTION! – This manual contains important instructions and warnings for personal safety. Carefully read all parts of this manual. If in doubt, suspend installation immediately and contact the Nice Technical Assistance.

CAUTION! – Important instructions: keep this manual in a safe place to enable future product maintenance and disposal procedures.

CAUTION! – All installation and connection operations must be performed exclusively by suitably qualified and skilled personnel with the unit disconnected from the main power supply.

- This product is suitable for indoor use. It may only be used outdoors in adequate weather conditions. The housing does not protect the product against the ingress of water or other liquids.
- The product packing materials must be disposed of in compliance with local regulations.

2 PRODUCT DESCRIPTION

IBT4EXT adapter enables the connection of the BiDi-WiFi or similar accessories to **Nice** control unit equipped with a BusT4 programming connector or fitted with a IBT4N programming connector that implement Opera system.

CAUTION! – Any use other than that specified herein or in environmental conditions other than those stated in this manual is to be considered improper and is strictly forbidden!

3 ELECTRICAL CONNECTIONS

IBT4EXT adapter enables the connection of the BiDi-WiFi or similar accessories to a single control unit using BusT4 cable. BiDi-WiFi is activated only when it is connected to the **IBT4EXT** and IBT4N is connected to control unit directly (see "**Figure 1**") or by means of the "IBT4N" connector on the unit, as it is powered by the control unit. To connect the IBT4N and **IBT4EXT**, see "**Figure 2**".

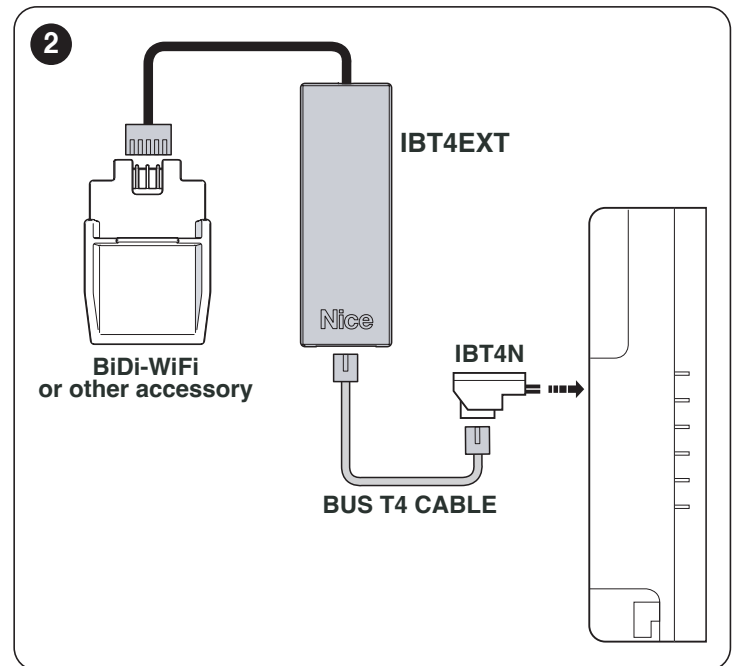
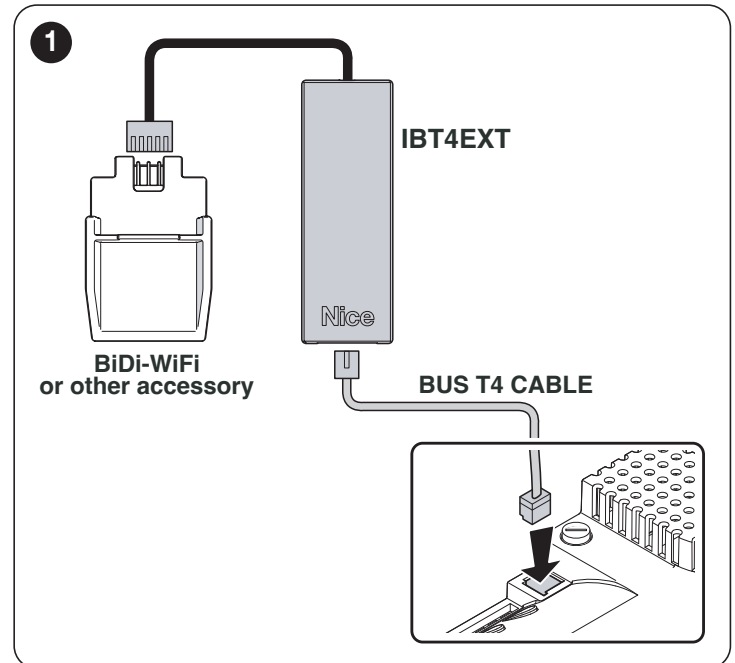

CAUTION! – Do not fit IBT4N in positions other than those specified. Before connecting IBT4N disconnect power to the control unit. After completing all connections, turn on the power supply.



CAUTION! – Using a custom cable is required to follow wiring diagram (Figure 3).

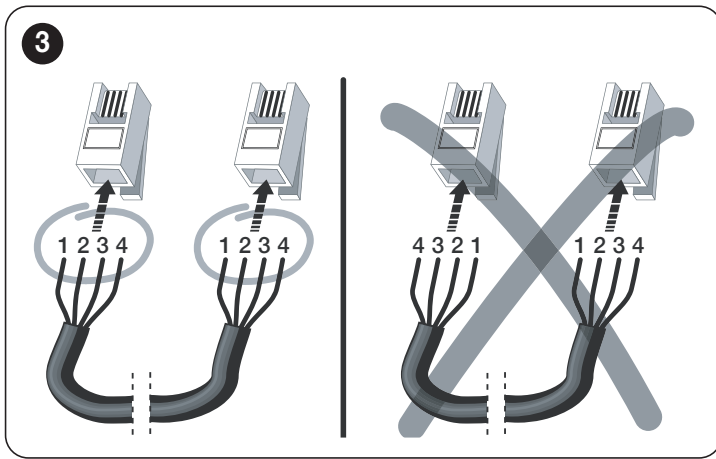

The wiring specifications must be as follows:

- **type of connector:** RJ11 6/4 plug (body 6 with 4 contacts), connectors normally used in telephone systems;
- **type of cable:** flat telephone cable with 4 wires.

4 TECHNICAL SPECIFICATIONS



All technical specifications stated in this section refer to an ambient temperature of 20°C (± 5°C). Nice S.p.A. reserves the right to apply modifications to the product at any time when deemed necessary, without altering its functions and intended use.

Table 1

TECHNICAL SPECIFICATIONS	
Description	Technical specification
Product name	IBT4EXT
Type	Interface with adapter cable between the BiDi-WiFi (or similar accessory) and control units equipped with BusT4, or with additional IBT4N adapter.
Technology used	Half duplex 19200 bps serial connection on differential bus
Connection cable length	Up to 100 m (on BusT4 cable)
Power supply	Supplied by the control unit to which the IBT4N is connected
Absorbed current	Maximum 200 mA, equal to BiDi-WiFi connected module
Insulation	Class III
Casing protection rating (IP)	20 (use indoors or in protected environments only)
Operating temperature	-20°C ... +55°C
Dimensions (WxDxH)	53 x 17 x 18 mm (without cable)
Weight	11 g

5

PRODUCT DISPOSAL



This product is an integral part of the operator and must therefore be disposed of with it.

As with the installation, only qualified personnel must dismantle the product at the end of its life.

This product is composed of different types of materials. Some of these materials can be recycled; others must be disposed of. Please enquire about the recycling or disposal systems in place in your local area for this type of product.



WARNING

Some parts of the product may contain polluting or dangerous substances. If not disposed of correctly, these substances may have a damaging effect on the environment and human health.



As indicated by the symbol shown here, this product must not be disposed of with household waste. Separate the waste for disposal and recycling, following the methods stipulated by local regulations, or return the product to the seller when purchasing a new product.



WARNING

Local regulations may impose heavy penalties if this product is not disposed of in compliance with the law.

6

CONFORMITY

The EU declaration of conformity can be downloaded from the website www.niceforyou.com



Nice SpA
Via Callalta, 1
31046 Oderzo (TV)
Italia

www.niceforyou.com

IS1000A00END_17-11-2025